

Portion Control Grinder with 1 Hopper

ITEM# _____

PROJECT _____

DATE _____



Model G9HD*

(funnel not included)

Dimensions: 25"H x 8"W x 17.8"D

(63.5cm H x 20.3cm W x 45.2cm D)

Features

Portion Control Grinder

- Single hopper holds 9 lbs. (4.1 Kg) of coffee.
- Portion controlled for the right amount of coffee every time.
- Precision burrs for consistent, commercial-quality grind.
- G9T HD model has optional interface to BUNN brewers for multiple batch sizes.
- The G9T HD accommodates larger brew funnels.
- Three year warranty on grinding burrs.
- International electrical configurations available.

For current specification sheets and other information, go to www.bunn.com.

* International models may vary in appearance.

Related Products

Precision Burrs

All BUNN grinders use precision burrs to cut (not crush) the coffee beans and deliver consistent grind distribution. BUNN burrs are rated at a Rockwell hardness of 66C, resulting in an exceptionally long burr life.



Model	Agency Listing	International Model	Agency Listing
G9 HD	UL (ETL)	G9TA HD	CE
G9T HD	UL (ETL)		

Dimensions & Specifications

Model	Product #	Volts	Amps	Capacity	Cu. Ft.	Shipping Weight	Cord Attached
G9HD	05800.0001	120	9.4	9 lbs.	6	62 lbs. (28.1 kg)	Yes†
G9HD*	05800.0013	120	9.4	9 lbs.	6	62 lbs. (28.1 kg)	Yes†
G9T HD	05800.0003	120	9.4	9 lbs.	6	62 lbs. (28.1 kg)	Yes†
G9T HD	05800.0027	120	9.4	9 lbs.	5	67 lbs. (30.4 kg)	Yes†

G9T HD accepts large brew funnels for System III, Dual and other large BUNN® Brewers.

* Model has black decor. †Power cord (NEMA 5-15P) 15 Amp-120V machine only.

Electrical: 2-wires plus ground service rated 120V, 60Hz, circuit required, ¾ HP motor.

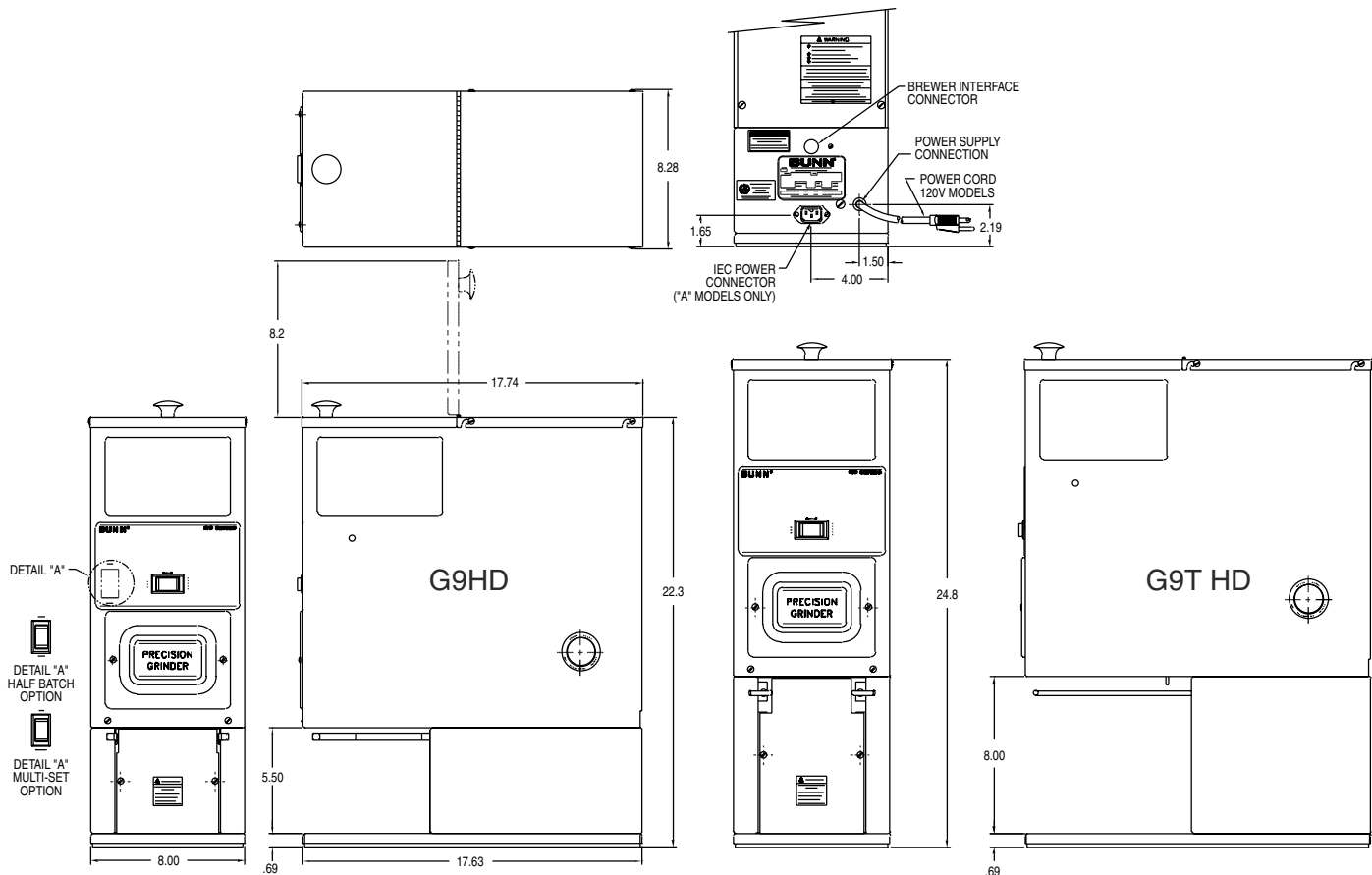

BUNN Corporation - 1400 Stevenson Drive Springfield, Illinois 62703 • 800-637-8606 • 217-529-6601 • Fax 217-529-6644 • www.bunn.com

BUNN® practices continuous product research and improvement. We reserve the right to change specifications and product design without notice. Such revisions do not entitle the buyer to corresponding changes, improvements, additions or replacements for previously purchased equipment.

All dimensions shown in inches. Bunn Corporation owns all copyrights relating to materials in this publication. Please contact Bunn Corporation to request permission to reproduce any portion of this publication.